

SALONA 45 High Performance Racer "NAOMI II"

4 CABINS + SALOON - (8+1 berths)
2 WC + 3 SHOWERS

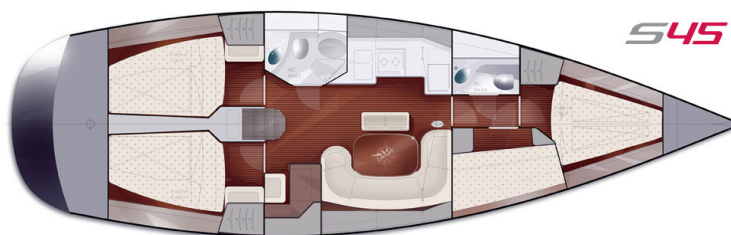

Year of production	2006.
Hull (length over all)	13.55 m
Beam (deck)	4.20 m
Draft deep (race) keel	2.55 m
Displacement	10.000 kg
Mainsail full batten	53 sqm
Furling Genoa	70 sqm
Water tank	480 l
Fuel tank	240 l
Engine	YANMAR 55 hp
Hull color	navy blue



Salona 45 equipment;

DECK EQUIPMENT

Harken performance deck hardware
Fullbatten mainsail
Lazy bag and lazy jack
Harken Genoa Roller MK III Unit 2,5
Navtec hydraulic Backstay Adjuster
Deep (Race) keel II, cast iron fin + antimony
hardened lead bulb

Frederiksen/Ronstan's Ballslide Mast sliding system with Torlon balls
Spring mooring Cleats (stainless steel)
Rod Standing rigging
Spectra Running rigging (all halyards)
Spectra Sheets & Ropes

Aluminium Spinnaker Pole
Spinnaker Deck Hardware
Tangun Spinnaker
Harken deck hardware winches x 6

Sun Cover
Sprayhood (with stainless steel tubes)
Teak massive in cockpit
Teak massive on deck
Maestral 230 inflatable dinghy



NAVIGATION EQUIPMENT - ELECTRONIC PACKAGE

Wind instrument system Raymarine ST60
GPS Chartplotter Raychart 435 (includes external GPS antenna)
Autopilot Raymarine ST6001
Tridata (Speed/Depth/Log) instrument system Raymarine ST 60
Whitlock Steering Wheel 60"
Electric anchor windlass 1500W, alu. spinnaker
Compass Plastimo
Sea charts
Binocular, Hand bearing compass

COMFORT ON BOARD

Hot water
Electric refrigerator
3-burner cooker with oven
Swimming ladder
Shower (hot&cold water) in cockpit (stern)
Audio package 1: CD/Radio VDO Marine + 2 Speakers in Saloon
2 Waterproof Speakers in cockpit



AB OVO SALONA CLUB d.o.o.

YACHT CHARTER & SAILING SCHOOL

Obala K. Tomislava bb,
21213 K.Gomilica – Croatia

Tel: +385 21 222 511 , Fax: +385 21 222 519